

PG0-Series Gear Pumps

- High strength extruded aluminum body.
- Hardened and ground integral gear shaft.
- Special aluminum alloy bush bearing.
- Axially balanced for high volumetric efficiency in excess of 95%.

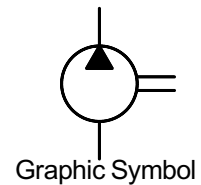

Specifications

| Model Number | Geometric Displacement cm ³ /rev. | Maximum Pressure Kg/cm ² | | Shaft Speed Range r/min. | | Mass (Kg) (Approx.) |
|--------------|--|-------------------------------------|--------------|--------------------------|------|---------------------|
| | | Continuous | Intermittent | Max. | Min. | |
| PG0-100 | 1.0 | 210 | 230 | 3000 | 1000 | 1.5 |
| PG0-160 | 1.6 | | | 3000 | 800 | |
| PG0-210 | 2.1 | 200 | 220 | 3000 | 600 | |
| PG0-320 | 3.2 | | | | | |
| PG0-420 | 4.2 | 190 | 220 | | | |
| PG0-530 | 5.3 | 180 | 210 | | | |
| PG0-640 | 6.4 | 160 | 190 | | | 1.7 |

Model Number Designation

| PG0 | -100 | -S | -1 | -S | -B | -R | -30 | 80 |
|--------|--------|----------------------------|---|---|---------------------------|---|---------------|-------------|
| Series | Size | Shaft | Mounting | Port | Drive Shaft Seal | Direction of Rotation (Viewed from Shaft End) | Design Number | Design Std. |
| PG0 | 100 | P: Straight with Snap Ring | 1: SAE 'A' 2 Bolt *1 2: SAE 'AA' 2 Bolt 3: Rectangular *2 | P: BSPF Port F: Flange *1 S: SAE 'O' Ring Port *1 | B: Nitrile V: *1 Viton | R: Clockwise L: Counter Clockwise | 30 | 80 |
| | 160 | | | | | | | |
| | 210 | S: Straight *1 | | | | | | |
| | 320 | | | | | | | |
| | 420 *1 | T: Taper (1:8) *1 | | | | | | |
| | 530 | U: Spline *1 | | | | | | |
| 640 | | | | | | | | |

*1 Consult factory for availability.

*2 Rectangular mounting available in T: Taper Shaft only.

Seals

B: Nitrile (Temp. range:- 15°C + 80°C)
V: Viton (Temp. range:- 10°C + 140°C)

Spare Parts List

List of Seals

| Sl No. | Name of Parts | Part Numbers | | Qty. |
|--------|---------------|--------------|------------|------|
| | | Nitrile | Viton | |
| 1 | Back up seal | A200 01 35 | A200 01 35 | 2 |
| 2 | Body End Seal | A200 01 34 | A200 01 36 | 2 |
| 3 | Oil Seal | A200 01 13 | A200 01 23 | 1 |

Note: When ordering the seals, please specify the seal kit number
KS-PG0-B for Nitrile
KS-PG0-V for Viton

General Arrangement

SAE 'A' 2-Bolt (For 'P' Shaft)

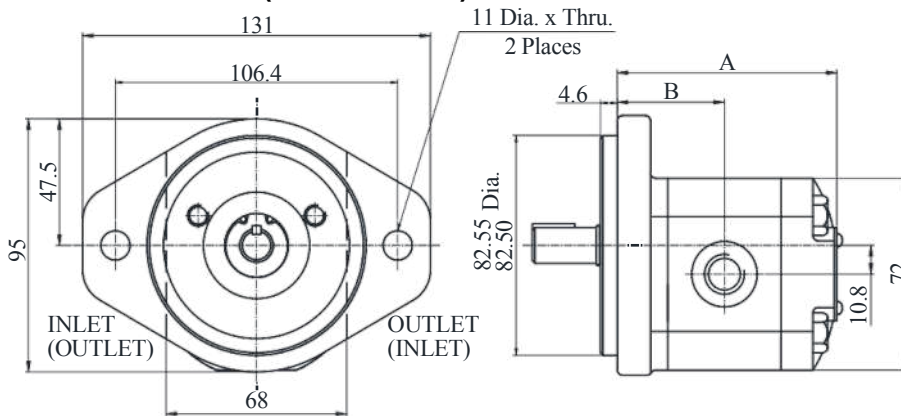

| Model Number | A | B |
|--------------|------|------|
| PG0 - 100 | 72.2 | 35.1 |
| PG0 - 160 | 74.8 | 36.4 |
| PG0 - 210 | 77.0 | 37.5 |
| PG0 - 320 | 81.9 | 40.0 |
| PG0 - 420 | 86.3 | 42.2 |
| PG0 - 530 | 91.1 | 44.6 |
| PG0 - 640 | 95.9 | 47.0 |

SAE 'A' 2-Bolt (For 'S' Shaft)

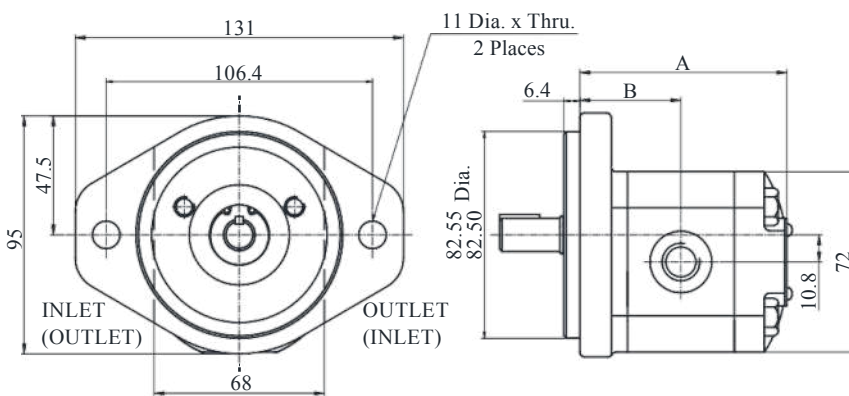

| Model Number | A | B |
|--------------|------|------|
| PG0 - 100 | 72.2 | 35.1 |
| PG0 - 160 | 74.8 | 36.4 |
| PG0 - 210 | 77.0 | 37.5 |
| PG0 - 320 | 81.9 | 40.0 |
| PG0 - 420 | 86.3 | 42.2 |
| PG0 - 530 | 91.1 | 44.6 |
| PG0 - 640 | 95.9 | 47.0 |

SAE 'AA' 2 Bolt

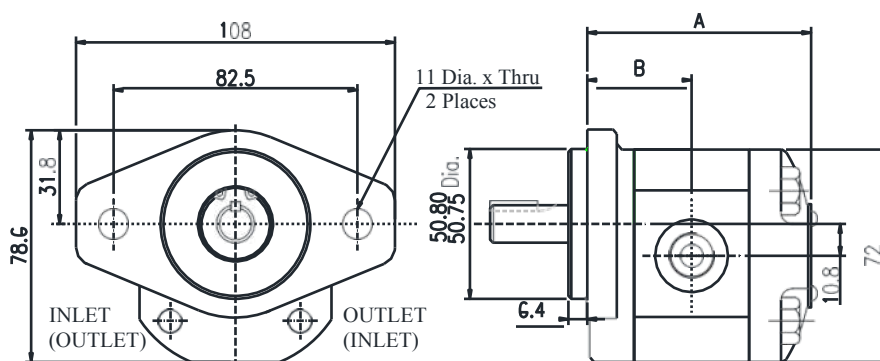

| Model Number | A | B |
|--------------|------|------|
| PG0 - 100 | 68.9 | 31.9 |
| PG0 - 160 | 71.6 | 33.2 |
| PG0 - 210 | 73.8 | 34.3 |
| PG0 - 320 | 78.6 | 36.7 |
| PG0 - 420 | 83.0 | 38.9 |
| PG0 - 530 | 87.9 | 41.3 |
| PG0 - 640 | 92.7 | 43.7 |

Rectangular

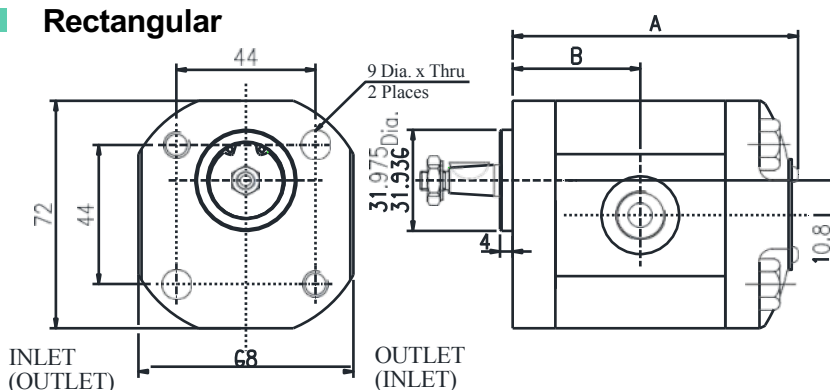

| Model Number | A | B |
|--------------|------|------|
| PG0 - 100 | 66.6 | 29.6 |
| PG0 - 160 | 69.3 | 30.9 |
| PG0 - 210 | 71.5 | 32.0 |
| PG0 - 320 | 76.3 | 34.4 |
| PG0 - 420 | 80.7 | 36.6 |
| PG0 - 530 | 85.6 | 39.0 |
| PG0 - 640 | 90.4 | 41.4 |

DIMENSIONS IN
MILLIMETRES

Shaft Details

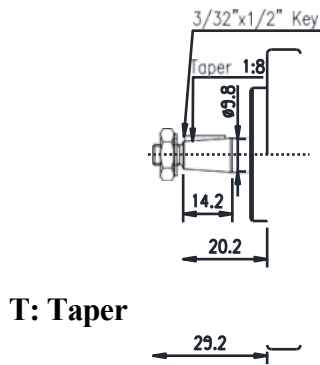
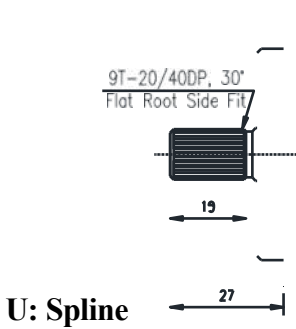
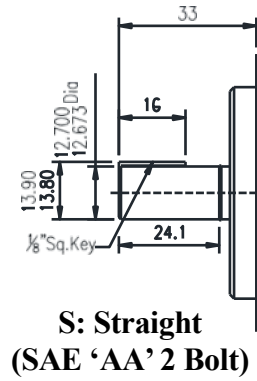
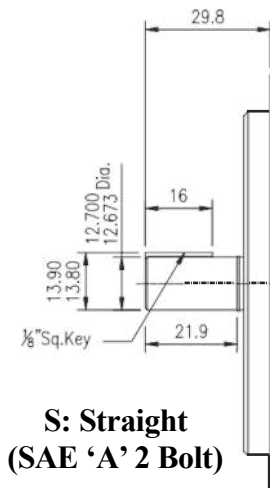
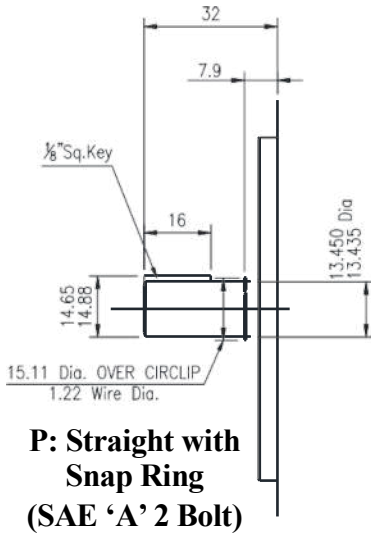

Ports

| Model Number | P: BSP.F Ports | | S: SAE O-Ring Ports | | F: Flange | |
|--------------|----------------|--------|---------------------|----------|-----------|--------|
| | Inlet | Outlet | Inlet | Outlet | Inlet | Outlet |
| PG0-100 | 3/8" | 3/8" | 9/16"-18 | 9/16"-18 | ---- | ---- |
| PG0-160 | 3/8" | 3/8" | 9/16"-18 | 9/16"-18 | ---- | ---- |
| PG0-210 | 3/8" | 3/8" | 3/4"-16 | 3/4"-16 | ---- | ---- |
| PG0-320 | 3/8" | 3/8" | 3/4"-16 | 3/4"-16 | Ø12 | Ø12 |
| PG0-420 | 1/2" | 1/2" | 3/4"-16 | 3/4"-16 | Ø12 | Ø12 |
| PG0-530 | 1/2" | 1/2" | 7/8"-14 | 7/8"-14 | Ø12 | Ø12 |
| PG0-640 | 1/2" | 1/2" | 7/8"-14 | 7/8"-14 | Ø12 | Ø12 |

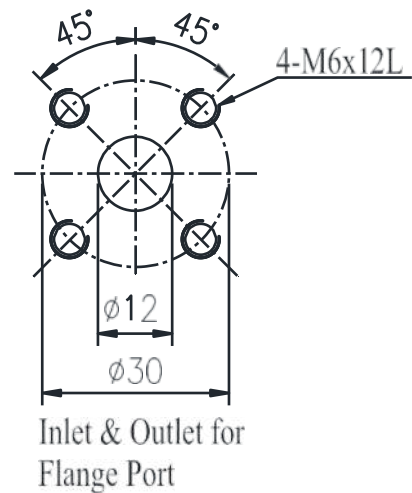

Speed Vs. Flow

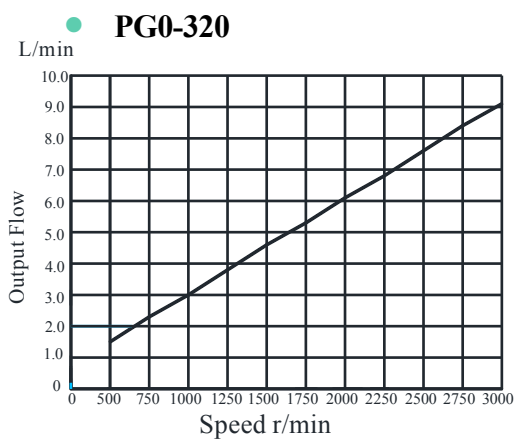
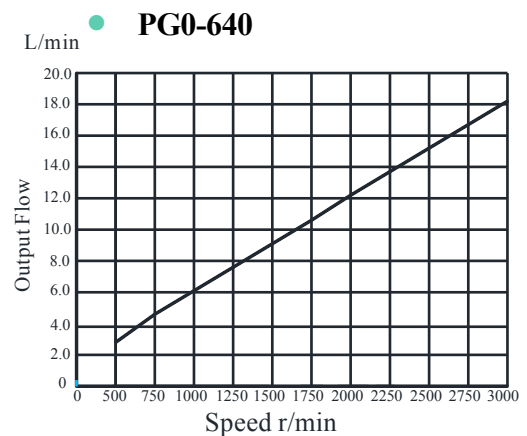
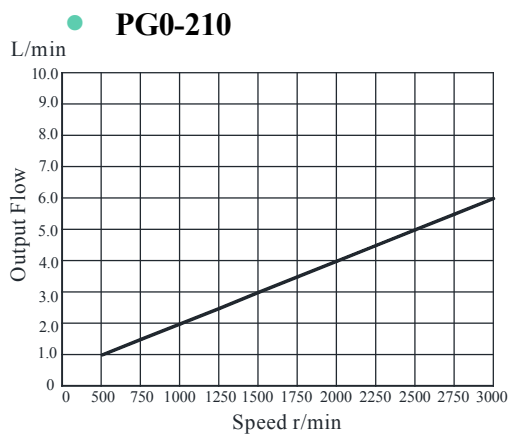
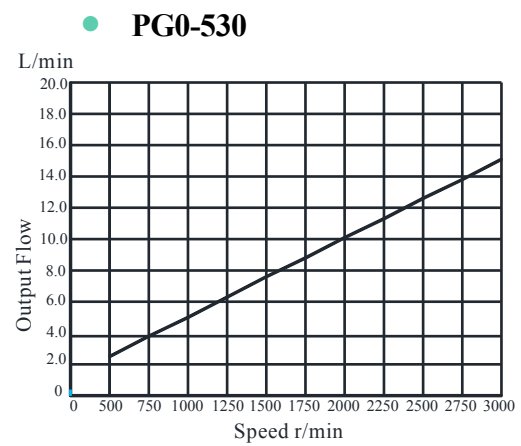
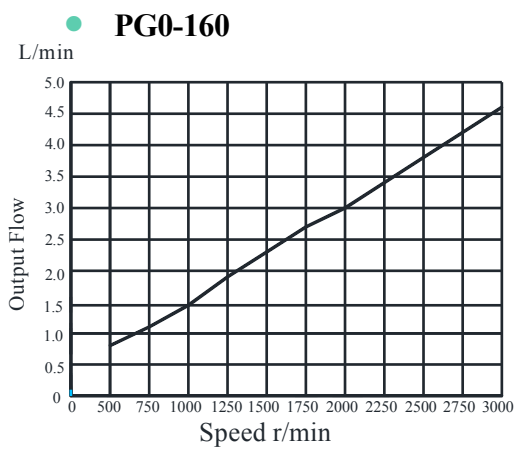
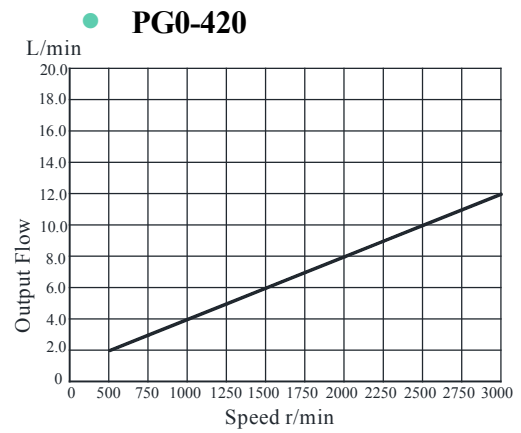
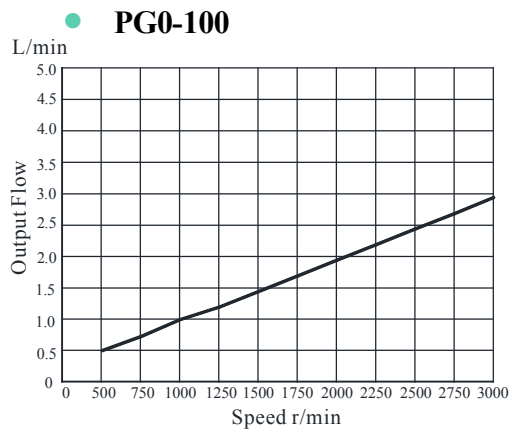

■ Pressure Vs. Input Power

